

# ABS SUBMERSIBLE WASTEWATER PUMP AS



AS 0530... to 0641 DIN/EN 12050-2

AS 0830... to 0840 DIN/EN 12050-1

**Tough, reliable submersible pumps from 1 to 3 kW for clear water, wastewater and sewage for the dewatering of buildings and sites in private, commercial and communal areas and in industry**

## Applications

ABS submersible pumps of the AS series have been designed for the economical and reliable pumping of sewage and wastewater in private, trade and communal applications. The 2 inch version is especially suitable for pumping wastewater from underground garages.

The pumps of the AS series can be used for fixed applications with ABS automatic coupling system or as portable units. The Vortex hydraulics are particularly suitable for fluids containing fibrous or abrasive matter, and for sewage. The CONTRABLOCK -system is suitable for larger proportions of solid or fibrous matter.

These pumps are available both in standard and in explosion-proof versions in accordance with international standards e.g. EExd IIB T4 and FM / CSA approval  
Maximum medium temperature: 40° C continuous use, 60° C intermittent use (max.5 min).

## Identification Code

AS 0840 S 12 / 2. Ex

## Hydraulics

Pump series \_\_\_\_\_  
Discharge outlet DN[cm] \_\_\_\_\_  
Hydraulics number \_\_\_\_\_

## Motor:

Motor version: Ex \_\_\_\_\_  
Number of poles \_\_\_\_\_  
Motor power P<sub>2</sub> [kW]x10 \_\_\_\_\_  
Modular motor \_\_\_\_\_

## Construction

The water tight fully flood-proof motor and the hydraulic section form a compact robust unit.

## Motor

Single-phase 220-240~, 50 Hz and three-phase 400 V 3 ~, 2-pole (2900 min<sup>-1</sup>) and 4-pole (1450 min<sup>-1</sup>), insulation class F, protection type IP 68. Ex protection to international standards e.g. EExdIIBT4 and FM/CSA. (Consult ABS for Ex usage with frequency inverters).

## Bearings

The rotor shaft is supported in lubricated-for-life ball-bearings.

## Shaft Sealing

Shaft Sealing between motor and hydraulic section by means of high quality sealing unit using a silicon carbide mechanical seal, independent of direction of rotation and resistant to temperature shock, motor side: Lip seal oil lubricated.

## Discharge Outlet

DN 50 (G2") - Internal thread, DN 65 & DN 80 -flange.

## CONTRABLOCK-system

CONTRABLOCK-system consisting of spiral bottom plate with waved shearing inlet and open single channel impeller prevents blockage of the impeller where large proportions of solid or fibrous matter is present. Solids passage 30 mm on 0840 and 45 mm on 0641 CB version.

## Vortex Impeller

Hydraulic system with Vortex impeller. Solids passage 60 mm for 0630 and 0830 and 40 mm for AS 0530 and 0631 version.

## TCS-Thermo-Control-System

(Ex version only) with thermal sensors in the stator to give a warning and switch off the unit if excessive temperatures are reached in the motor.



- For wastewater, sewage and sludge containing solid or fibrous particles
- Hydraulic design with CONTRABLOCK System or Vortex impellers
- In standard or Ex-versions
- Option of automatic seal and temperature monitoring
- Ex version with temperature monitoring as standard
- High operational reliability even under continuous operating conditions
- Vortex version with discharge sizes 2", DN 65, DN 80
- Available in transportable version

## Materials

Motor housing \_\_\_\_\_ Cast Iron GG-25  
Motor shaft \_\_\_\_\_ Stainless Steel 1.4021 (AISI 420)  
Volute \_\_\_\_\_ Cast Iron GG-25  
Impeller, bottom plate \_\_\_\_\_ Cast Iron GG-25  
Fasteners \_\_\_\_\_ Stainless Steel 1.4401 (AISI 316)

# ABS SUBMERSIBLE WASTEWATER PUMPS

## Technical Data

Pump	Motor type	Hydraulics			Motor power*		Speed at 50 Hz min <sup>-1</sup>	Rated voltage V	Rated current A	Cable type**		Weight*** kg
		Standard	Ex	Discharge	P <sub>1</sub> kW	P <sub>2</sub> kW				Stand	Ex	
<b>AS 0530</b>	S12/2 W	(Ex)	V	G 2"	1.8	1.2	2900	220-240~ Single-Phase	8.2	(1)	(2)	34
<b>0530</b>	S12/2 D	(Ex)	V	G 2"	1.7	1.2	2900	400 Three-Phase	3.3	(1)	(2)	34
<b>0530</b>	S17/2 D	(Ex)	V	G 2"	2.3	1.7	2900	400 Three-Phase	4.0	(1)	(2)	34
<b>0530</b>	S26/2 D	(Ex)	V	G 2"	3.4	2.6	2900	400 Three-Phase	5.6	(1)	(2)	40
<b>0630</b>	S10/4 W	(Ex)	V	DN 65	1.7	1.0	1450	220-240~ Single-Phase	7.5	(1)	(2)	37
<b>0630</b>	S13/4 D	(Ex)	V	DN 65	1.9	1.3	1450	400 Three-Phase	3.6	(1)	(2)	37
<b>0630</b>	S22/4 D	(Ex)	V	DN 65	2.9	2.2	1450	400 Three-Phase	5.2	(1)	(2)	42
<b>0631</b>	S12/2 W	(Ex)	V	DN 65	1.8	1.2	2900	220-240~ Single-Phase	8.2	(1)	(2)	38
<b>0631</b>	S12/2 D	(Ex)	V	DN 65	1.7	1.2	2900	400 Three-Phase	3.3	(1)	(2)	38
<b>0631</b>	S17/2 W	(Ex)	V	DN 65	2.4	1.7	2900	220-240~ Single-Phase	10.6	(1)	(2)	38
<b>0631</b>	S17/2 D	(Ex)	V	DN 65	2.3	1.7	2900	400 Three-Phase	4.0	(1)	(2)	38
<b>0631</b>	S30/2 D	(Ex)	V	DN 65	3.6	3.0	2900	400 Three-Phase	6.2	(1)	(2)	46
<b>0641</b>	S30/2 D	(Ex)	CB	DN 65	3.7	3.0	2900	400 Three-Phase	6.2	(1)	(2)	42
<b>0830</b>	S10/4 W	(Ex)	V	DN 80	1.7	1.0	1450	220-240~ Single-Phase	7.5	(1)	(2)	40
<b>0830</b>	S13/4 D	(Ex)	V	DN 80	1.9	1.3	1450	400 Three-Phase	3.6	(1)	(2)	40
<b>0830</b>	S22/4 D	(Ex)	V	DN 80	2.9	2.2	1450	400 Three-Phase	5.2	(1)	(2)	42
<b>0840</b>	S12/2W	(Ex)	CB	DN 80	1.8	1.2	2900	220-240~ Single-Phase	8.2	(1)	(2)	35
<b>0840</b>	S12/2 D	(Ex)	CB	DN 80	1.7	1.2	2900	400 Three-Phase	3.3	(1)	(2)	35
<b>0840</b>	S17/2 D	(Ex)	CB	DN 80	2.3	1.7	2900	400 Three-Phase	4.0	(1)	(2)	35
<b>0840</b>	S26/2 D	(Ex)	CB	DN 80	3.4	2.6	2900	400 Three-Phase	5.6	(1)	(2)	40

\*P<sub>1</sub> = Power taken from the mains; P<sub>2</sub> = Power at the motor shaft  
 \*\*Special rubber compound cable with free cable ends; (1) 4G1.5, (2) 7G1.5  
 \*\*\* Weight with 10 m of cable

## Performance Curves 50 Hz

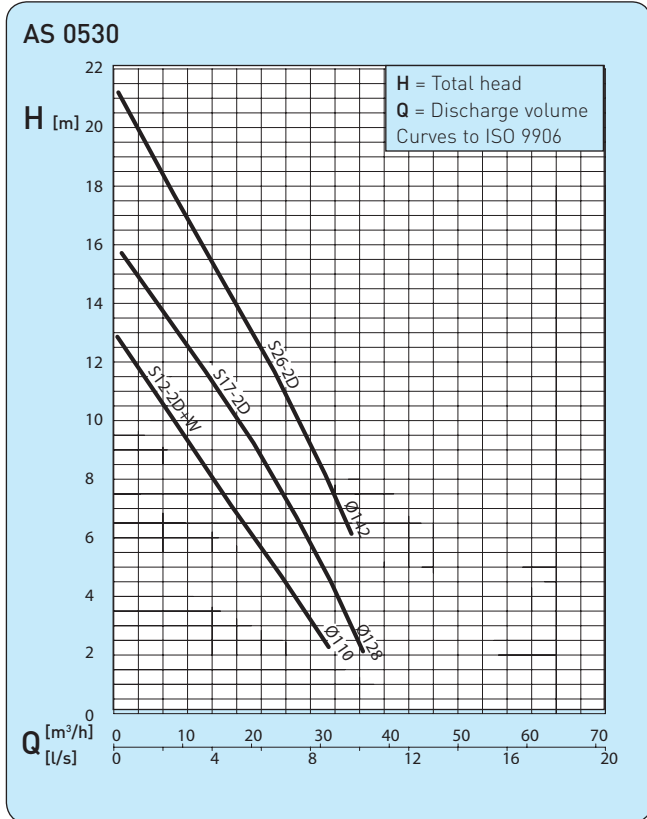

Performance curves for 60 Hz are available on request.

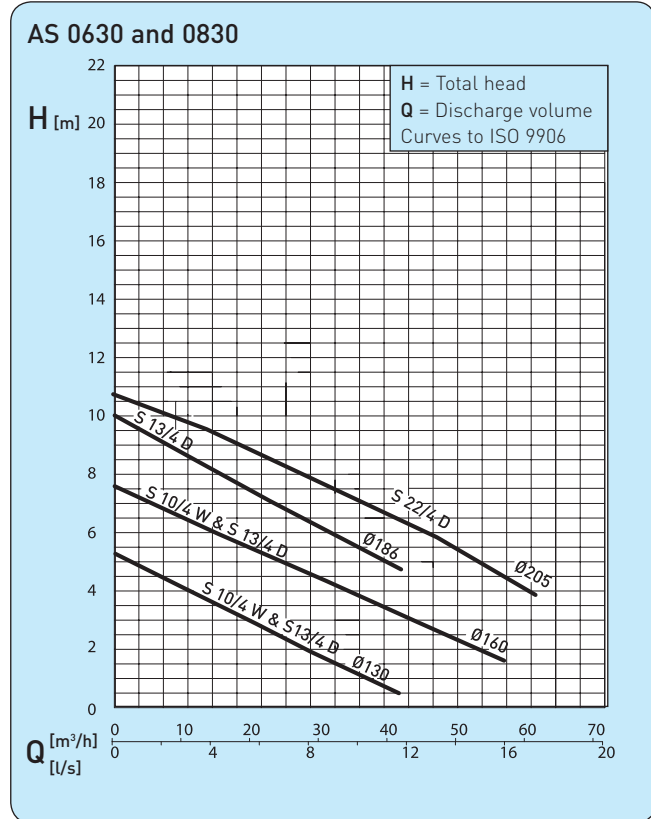

Performance curves for 60 Hz are available on request.

# ABS SUBMERSIBLE WASTEWATER PUMP AS

## Performance Curves 50 Hz

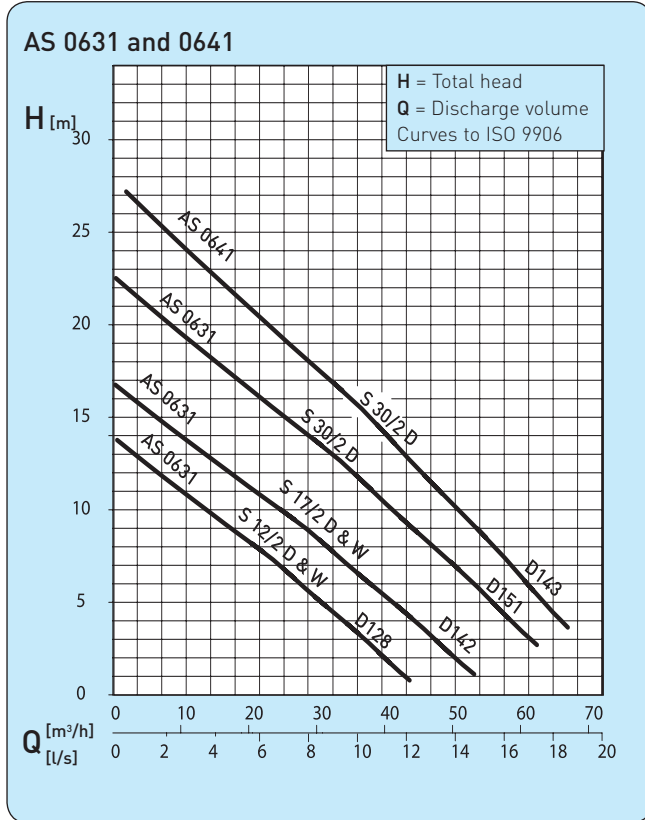

Performance curves for 60 Hz are available on request.

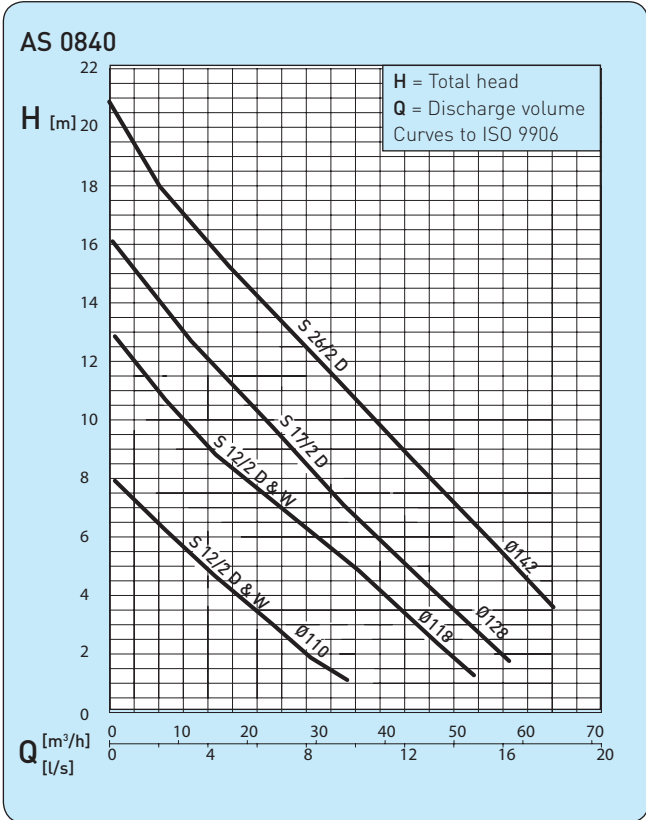

Performance curves for 60 Hz are available on request.

## Dimensions

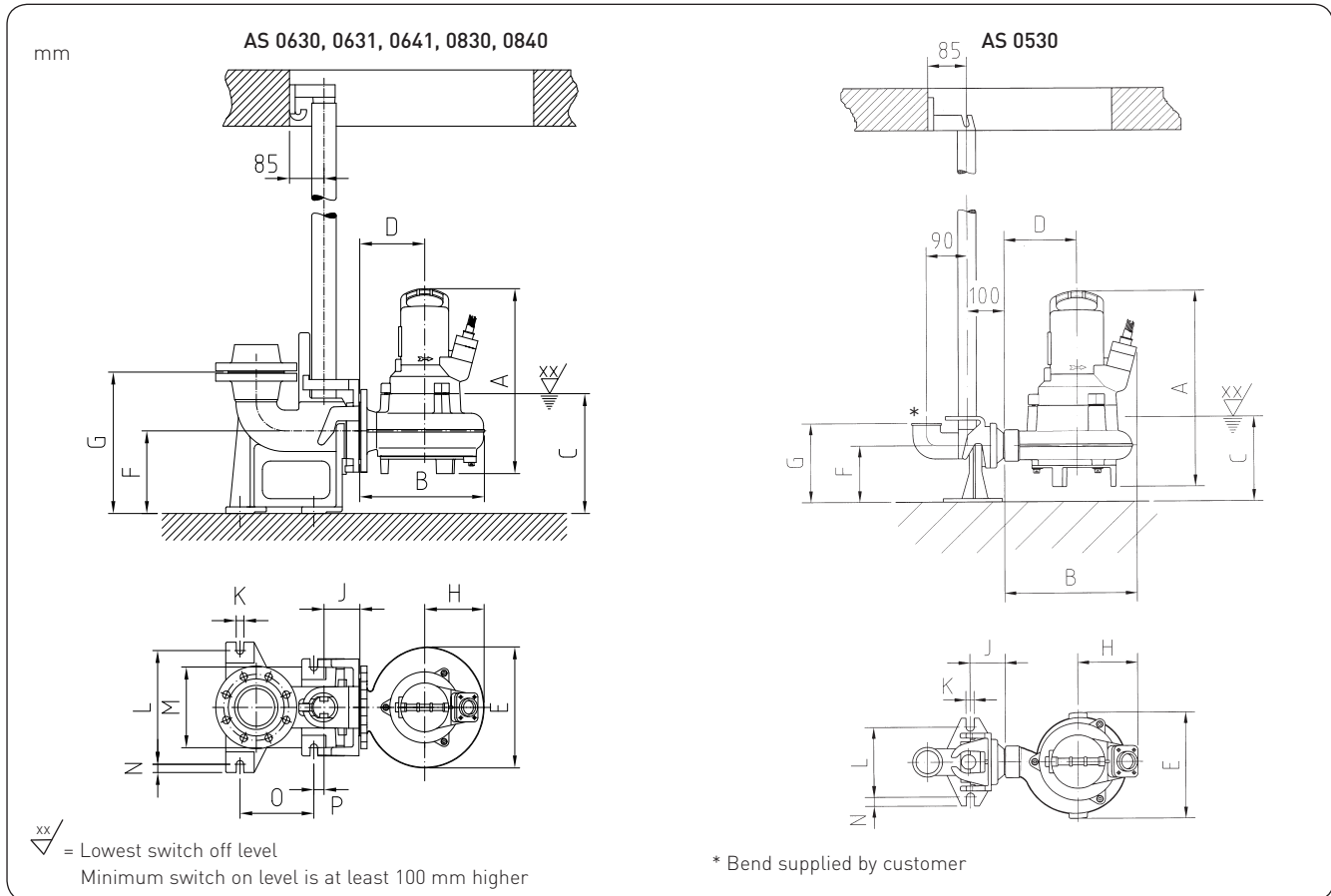

# ABS SUBMERSIBLE WASTEWATER PUMPS

## Dimensions

	A	B	C	D	E	F	G	H	J	K	L	M	N	O	P
AS 0530 S 12 / 2 & 17/2	432	292	188	160	236	125	175	131	100	18	155	N/A	20	N/A	N/A
AS 0530 S 26 / 2	444	292	188	160	236	125	175	131	100	18	155	N/A	20	N/A	N/A
AS 0630 S 10 / 4 & 13/4	437	307	140	160	294	140	247	147	57	18	245	195	20	132	40
AS 0630 S 22 / 4	450	307	140	160	294	140	247	147	57	18	245	195	20	132	40
AS 0631 S 12 / 2 & 17/2	415	308	172	160	237	140	247	148	54	18	245	195	20	132	N/A
AS 0631 S 30 / 2	428	308	172	160	237	140	247	148	54	18	245	195	20	132	N/A
AS 0641 S 30 / 2	428	270	172	160	236	140	247	146	54	18	245	195	20	132	40
AS 0830 S 10 / 4 + 13/4	437	307	200	160	294	200	342	147	88	18	275	195	20	182	25
AS 0830 S 22 / 4	450	307	200	160	294	200	342	147	88	18	275	195	20	182	25
AS 0840 S 12 / 2 + 17/2	418	250	200	130	210	200	342	146	88	18	275	195	20	182	25
AS 0840 S 26 / 2	430	250	200	130	210	200	342	146	88	18	275	195	20	182	25

## Prefabricated pump stations

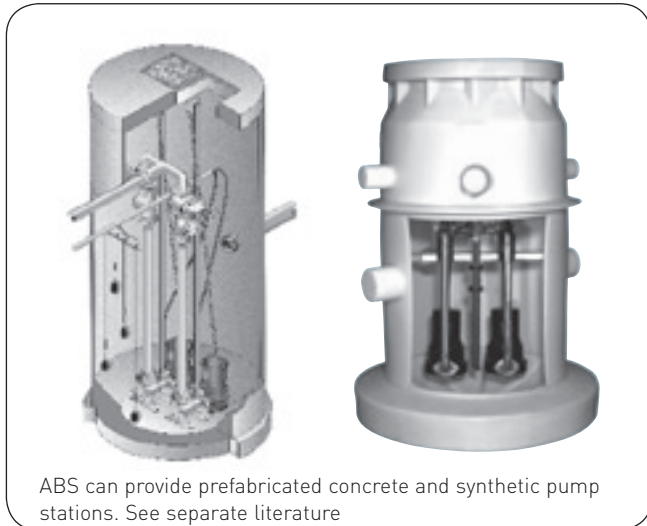

## Accessories

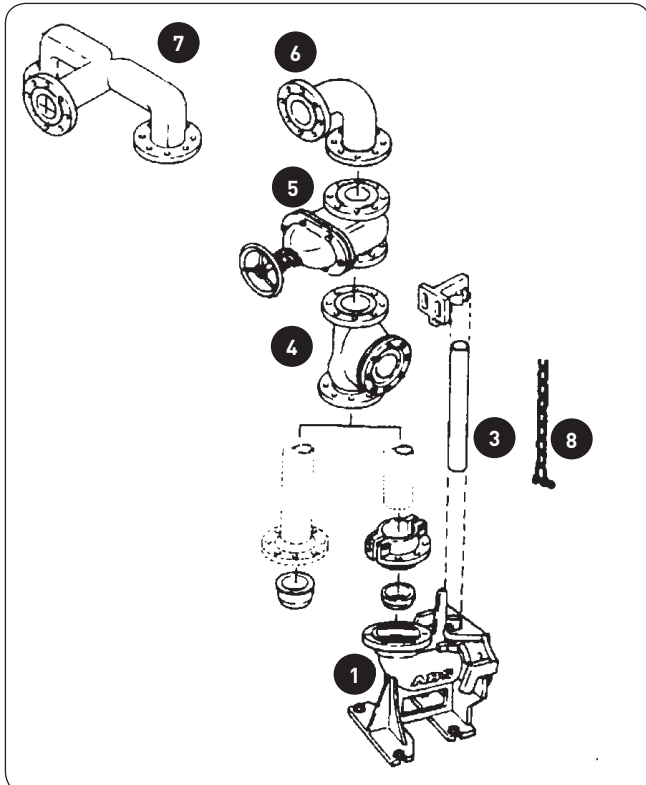

## Fixed Installation with ABS Automatic Coupling System

Description (Material)	Size	Part No.
<b>1</b> Pedestal (GG-25) for ABS automatic coupling system with DIN/EN flange fastening	2" without bend DN 65 with bend DN 80 with bend	62320560 62320673 62320649
<b>3</b> Guide tube (steel galv.)	2" 1 m 2 m 3 m 4 m 5 m 6 m	31380001 31380002 31380003 31380004 31380005 31380006

Discharge pipe on request, please give DN and L

<b>4</b> Ball type non-return valve (GG-25) with inspection opening and venting mechanism including 1 set of bolts and 1 gasket, flanges to PN 16 [DN 80] 2" and 2½" [DN 65] threaded ends	2" DN 65 DN 80	61400513 61400543 61400534
<b>5</b> Gate valve (GG-25) including hand wheel, 1 set of bolts and 1 gasket, flanges to PN 16	G 2" DN 80	14040007 61420500
<b>6</b> 90° Bend, Q-piece, (SG iron to DIN/EN only for single pumping station)	DN 80	62610302
<b>7</b> Junction piece (St. 37 steel) to join the two discharge lines in the case of a twin-pump station	DN 80/80/80 DN 80/100/80	62610001 62610002

Description (Material)	Size	Part No.
<b>8</b> Chain Kit (steel, galv.) including shackle	3m 4m 6m 7m	61265065 61265093 61265069 61265096

